

01

**Ferramentas
em diamante policristalino**
Herramientas
de diamante policristalino



araújo&silva
ferramentas de corte

JÁ MEDIU A SUA PRODUTIVIDADE?



A Araujo&Silva, Lda. desenvolve ferramentas especiais, proporcionando aos seus clientes as soluções mais rentáveis.

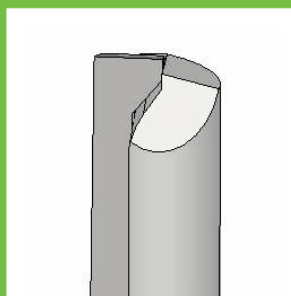
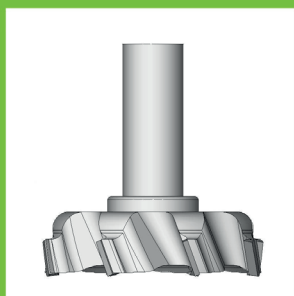

araújo&silva
ferramentas de corte

ESPECIALISTAS EM FERRAMENTA DE CORTE

www.araujosilva.pt



DP · MEC

D	B	b	d	Z	NL/TK	Ref.
H=4mm						
250	3.2	2.2	30	60	2/7/42+2/10/60	8200.001
	3.2	2.2	30	80	2/7/42+2/10/60	8200.002
300	3.2	2.2	30	72	2/7/42+2/10/60	8200.003
	3.2	2.2	30	84	2/7/42+2/10/60	8200.004
	3.2	2.2	30	96	2/7/42+2/10/60	8200.005
350	4.4	3.2	30	72		8200.006

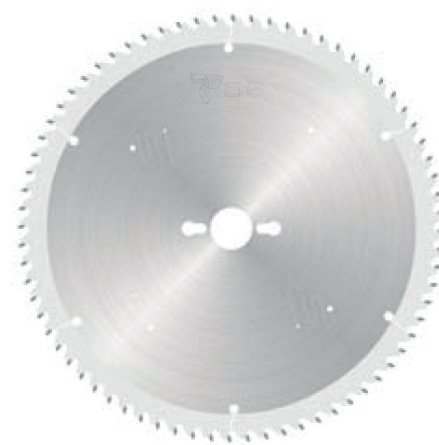

GEOMETRIA DO CORTANTE: T
Geometría del cortante: T

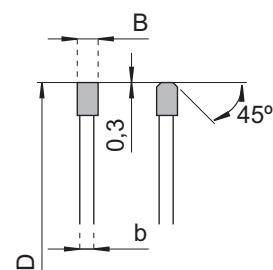

Serra circular 8201
Sierra circular

DP · MEC

D	B	b	d	Z	NL/TK	Ref.
H=5mm						
250	3.2	2.2	30	60	2/7/42+2/10/60	8201.001
	3.2	2.2	30	80	2/7/42+2/10/60	8201.002
300	3.2	2.2	30	72	2/7/42+2/10/60	8201.003
	3.2	2.2	30	84	2/7/42+2/10/60	8201.004
	3.2	2.2	30	96	2/7/42+2/10/60	8201.005

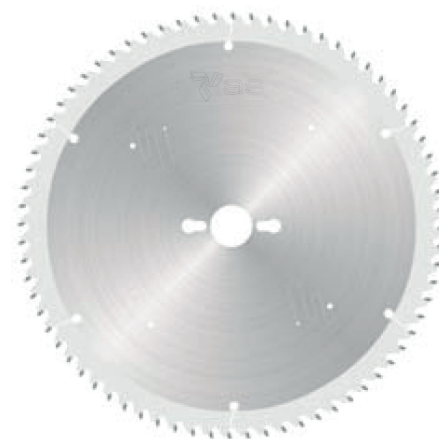

GEOMETRIA DO CORTANTE: T
Geometría del cortante: T

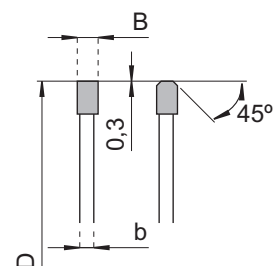

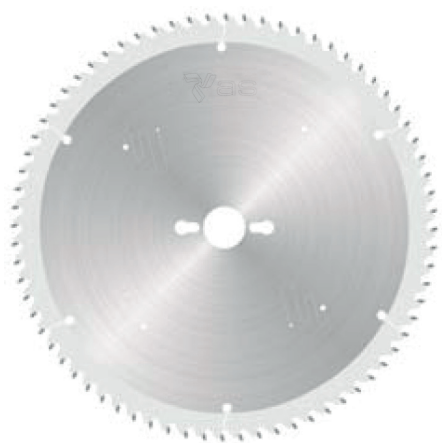

GEOMETRIA DO CORTANTE: TF
Geometría del cortante: TF

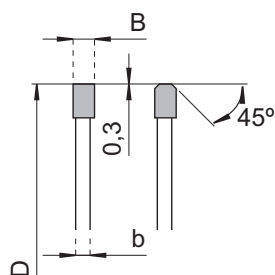

DP · MEC

D	B	b	d	Z	NL/TK	Ref.
H=5mm						
300	4.4	3.2	80	72	4/9/100+2/7/110+2/14/110	Gabbiani 8202.001
320	4.4	3.2	65	72	2/9/110	Selco 8202.002
350	4.4	3.2	60	72	2/14/100	Holzman 8202.003
	4.4	3.2	50	72	4/13/80	Giben 8202.004
	4.4	3.2	80	72	4/9/100+2/7/110+2/14/110	Gabbiani 8202.005
380	4.8	3.5	60	72	2/14/100	Holzman 8202.006
400	4.4	3.2	75	72	4/15/105	Giben 8202.007
	4.4	3.2	80	72	4/8.5/100+2/7/110+2/14/110	Gabbiani 8202.008
	4.4	3.2	80	72	4/19/120+2/9/130	Selco 8202.009
420	4.4	3.2	80	72	4/8.5/100+2/7/110+2/14/110	Gabbiani 8202.010
	4.8	3.5	60	72	2/14/125	Holzman 8202.011
430	4.4	3.2	75	96	4/15/105	Giben 8202.012
450	4.4	3.2	80	72	4/19/120+2/9/130	Selco 8202.013
	4.8	3.5	60	72	2/14/125+2/17/100	Holzman 8202.014
470	4.4	3.2	75	72	4/15/105	Giben 8202.015
480	4.8	3.5	60	72	2/19/120	Holzman 8202.016
	4.8	3.5	80	72	4/19/120+2/9/130	Selco 8202.017

Seccionadora vertical

Seccionadora vertical

D	B	b	d	Z	NL/TK	Ref.
H=5mm						
300	4.4	3.2	75	96	Homag CV`S	8202.100
	4.48	3.2	75	96	Homag CV`S	8202.101



DP · MEC

D	B	d	Z	NL/TK	Ref.
H=5mm					
125	4.4/5.4	45	18		Homag CV'S 8250.001
125	4.4/5.6	20	24		Gabbiani 8250.002
160	4.4/5.6	45	28	3/11/70	Giben 8250.003
160	4.4/5.6	55	36	3/7/66	Gabbiani 8250.004
180	4.4/5.6	45	36		Holzman 8250.005
180	4.4/5.6	50	42	3/13/80	Giben 8250.006
180	4.8/5.8	45	36		Holzman 8250.007
200	4.4/5.6	65	36	2/9/100+2/9/110	Selco 8250.008
200	4.8/5.8	45	36		Holzman 8250.009
200	4.8/5.8	65	36	2/9/100+2/9/110	Selco 8250.010
215	4.4/5.6	50	42	3/15/80	Giben 8250.011



GEOMETRIA DO CORTANTE: K
Geometría del cortante: K

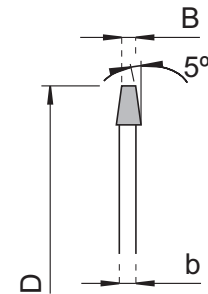

DP · MEC

D	B	d	Z	NL/TK	Ref.
H=4mm					
120	3.2/4.2	20	18		8251.001
125	3.2/4.2	20	18		8251.002
150	4.4/5.4	30	24		8251.003
180	4.4/5.4	30	30		8251.004

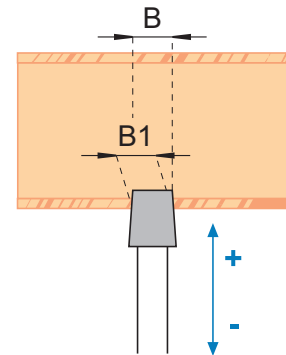
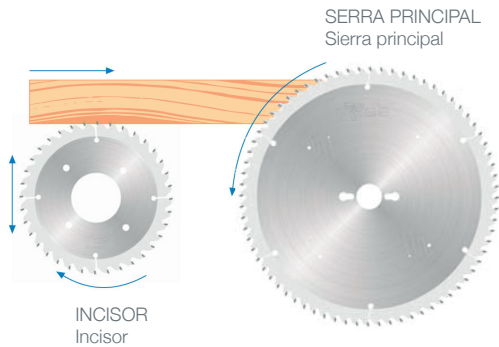

A LARGURA DA RANHURA (B1) É OBTIDA PELO AJUSTE DA ALTURA DE INCISOR. AUMENTANDO A ALTURA DO INCISOR RESULTA UM AUMENTO DA LARGURA DA RANHURA (B1).

El ancho de la ranura (B1) se obtiene por el ajuste de la altura del incisor. Aumentando su altura, resulta un aumento del ancho de ranura (B1)



GEOMETRIA DO CORTANTE: FV
Geometría del cortante: FV

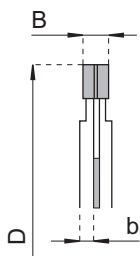

DP · MEC

D	B	d	Z		Ref.
H=5mm					
80	2.8-3.6	20	2x10	Felder	8252.001
100	2.8-3.6	20	2x12	Panhans – Schelling	8252.002
	2.8/3.6	22	2x12	Altendorf-Striebig	8252.003
120	2.8/3.6	20	2x12	HolzHer-SCM	8252.004
	2.8/3.6	22	2x12	Altendorf-Martin	8252.005
125	2.8/3.6	20	2x12	Paoloni	8252.006
	2.8/3.6	22	2x12	Paoloni	8252.007

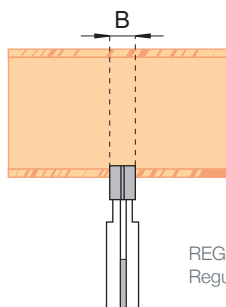

REGULAÇÃO COM ANILHAS DE AFINAÇÃO.
Regulación con anillos de ajuste

DP · MEC

D	B	d	Z		Ref.
H=4mm					
120	2.8/3.6	20	2x12		8253.001
125	2.8/3.6	20	2x12		8253.002

8300 Triturador
Triturador



DP · MEC

D	B	d	Z	n max	Ref. Esq.	Ref. Drt.
H=5mm						
250	10/20	80	30+6+6	7000	8300.501	8300.001
	10/20	80	36+6+6	7000	8300.502	8300.002
	10/20	80	42+6+6	7000	8300.503	8300.003
	10/20	80	48+6+6	7000	8300.504	8300.004
	10/20	80	60+6+6	7000	8300.505	8300.005



DP · MEC

D	B	d	Z	n max	Ref.
H=5mm					
120	4	30	8	12000	8310.001
	5	30	8	12000	8310.002
	6	30	8	12000	8310.003
150	4	30	12	12000	8310.004
	5	30	12	12000	8310.005
	6	30	12	12000	8310.006

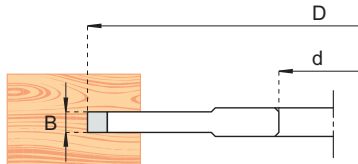
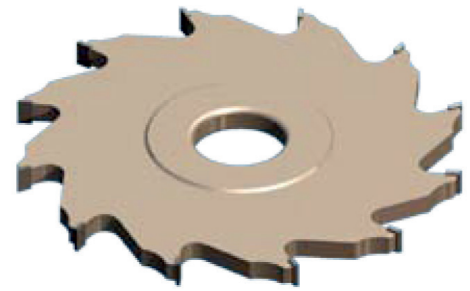

01

Ferramentas em diamante policristalino · Herramientas de diamante policristalino

Fresa de ranhurar extensível
Fresa de ranurar extensible

8311

DP · MAN

D	B	d	Z	T max	n max	Ref.
H=5mm						
100	3-5.5	30	4+4	12000	5200-8900	8311.001
150	4-7.5	30	6+6	12000	5200-8900	8311.002
200	7-13.5	30	6+6	12000	3900-6600	8311.003

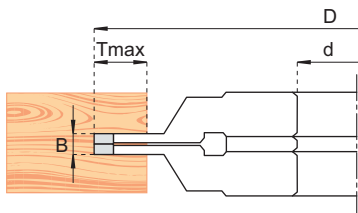
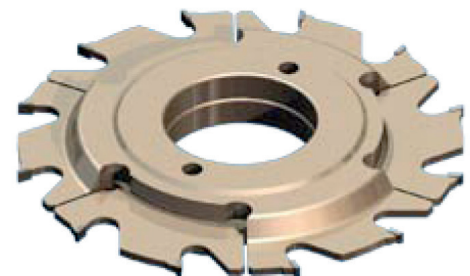



8312 Fresa para ranhurar e facejar

Fresa para ranurar y cantear



DP · MEC

D	B	d	Z	n max	Ref. Esq.	Ref. Drt.
H=5mm						
120	5	30	8	10000	8312.501	8312.001
	6	30	8	10000	8312.502	8312.002
150	5	30	12	10000	8312.503	8312.003
	6	30	12	10000	8312.504	8312.004

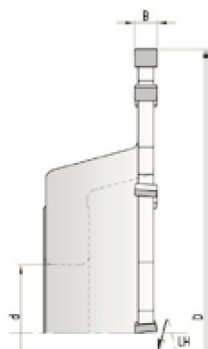

8313 Fresa de ranhurar extensível

Fresa de ranurar extensible



DP · MEC

D	B	d	Z	n max	Ref. Esq.	Ref. Drt.
H=5mm						
120	4-7.5	30	8+8	10000	8313.501	8313.001
	7-13.5	30	8+8	10000	8313.502	8313.002
150	4-7.5	30	8+8	8500	8313.503	8313.003
	7-13.5	30	8+8	8500	8313.504	8313.004

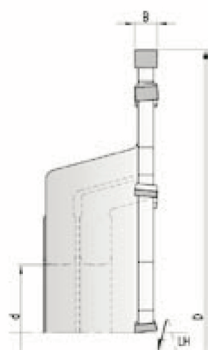



DP · MEC

D	B	d	Z	n max	Ref. Esq.	Ref. Drt.
H=5mm						
180	18-30	35DKN	4+4	9000	8314.501	8314.001
	18-30	35DKN	6+6	9000	8314.502	8313.002
160	18-30	35DKN	4+4	8000	8314.503	8313.003
	18-30	35DKN	6+6	8000	8314.504	8313.004

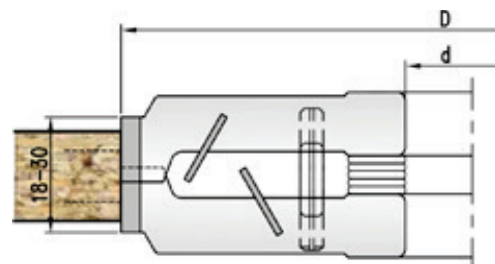

01

Ferramentas em diamante policristalino · Herramientas de diamante policristalino

Fresa para galgar painéis
Fresa para cantar

8315

DP · MEC

D	B/e	d	DKN	Z	Ref. Esq.	Ref. Drt.
H=3mm						
Biesse						
B+2	80	48/25	20	6.5x3.5	2(x2)	8315.501 8315.001
A+1	125	42/47	30	8x3	3(x2)	8315.502 8315.002
A+2	125	63/47	30	8x3	3(x6)	8315.503 8315.003
Cehisa						
B+2	100	50/25	20	6X3	2(x4)	8315.504 8315.004
SCM						
B+1	80	65/67	30	8X3	3(x3)	8315.505 8315.005
IMA/BRANDT						
B+1	100	34/36	30	8X3	3(x3)	8315.506 8315.006
B+3	100	44.5/40.6	30	8X3	3(x4)	8315.507 8315.007
IMA						
B+1	125	34/34	30	8X3	3(x3)	8315.508 8315.008
B+1	125	43/42	30	8X3	3(x4)	8315.509 8315.009
B+3	125	63/42	30	8X3	3(x6)	8315.510 8315.010
HOLZHER						
B+2	100	48/25	30	8X3	2(X4)	8315.511 8315.011
HOMAG						
A+1	125	34/36	30	8X3	3(X2)	8315.512 8315.012
A+2	125	63/40	30	8X3	3(X6)	8315.513 8315.013
B+1	180	43/58.8	35	10X3.3	4(X4)	8315.514 8315.014
B+1	180	63/58.8	35	10X3.3	4(X4)	8315.515 8315.015





8504 Fresa para ranhurar - SLICE

Fresa para ranurar - SLICE

01

Ferramentas em diamante policristalino · Herramientas de diamante policristalino



HW · MEC

D	L2	L1	S	Z	Ref.
12	27	75,5	12	1+1	8504.12.27.0
12	35	84	12	1+1	8504.12.35.0
16	27	88,5	20	1+1	8504.16.27.0
16	35	97	20	1+1	8504.16.35.0
16	44	105,5	20	1+1	8504.16.44.0
18	27	88,5	20	1+1	8504.18.27.0
18	35	97	20	1+1	8504.18.35.0
18	44	105,5	20	1+1	8504.18.44.0
18	52	114	20	1+1	8504.18.52.0
20	27	88,5	20	1+1	8504.20.27.0
20	35	97	20	1+1	8504.20.35.0
20	44	105,5	20	1+1	8504.20.44.0
20	52	114	20	1+1	8504.20.52.0

APLICAÇÃO

Para ranhurar, fresar, recortar, contornar, em máquinas CNC.

DESCRIÇÃO

Com cortante central em HW para furar. <12345

Avanço de 4-8m/min.

n: 18000-24000 rpm.

Económica relação qualidade/preço

Série económica

Reafável uma ou duas vezes





HW · MEC

D	L2	L1	S	Z	Ref.
12	27	75,5	12	1+1	8500.12.27.0
12	35	84	12	1+1	8500.12.35.0
16	27	88,5	20	1+1	8500.16.27.0
16	35	97	20	1+1	8500.16.35.0
16	44	105,5	20	1+1	8500.16.44.0
18	27	88,5	20	1+1	8500.18.27.0
18	35	97	20	1+1	8500.18.35.0
18	44	105,5	20	1+1	8500.18.44.0
18	52	114	20	1+1	8500.18.52.0
20	27	88,5	20	1+1	8500.20.27.0
20	35	97	20	1+1	8500.20.35.0
20	44	105,5	20	1+1	8500.20.44.0
20	52	114	20	1+1	8500.20.52.0

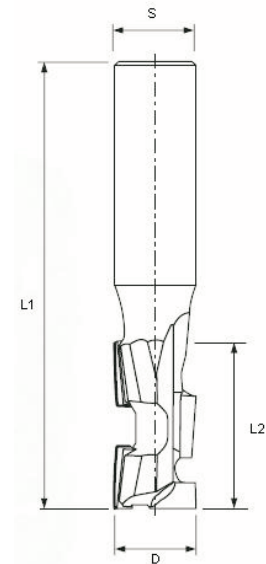

APLICAÇÃO

Para ranhurar, fresar, recortar, contornar; em máquinas CNC materiais como aglomerados, MDF em cru e revestidos com melamina, laminados, papel decorativo, etc... e madeiras duras, materiais termoplásticos, duroplásticos, compactos, Trespa, Corion etc.

DESCRIÇÃO

Com cortante central em HWV para furar.

Avanço de 4-8m/min.

n: 18000-24000 rpm.

Grande área disponível para afiamentos





8501 Fresa de ranhurar Multidentente

Fresa para ranhurar Multidentente

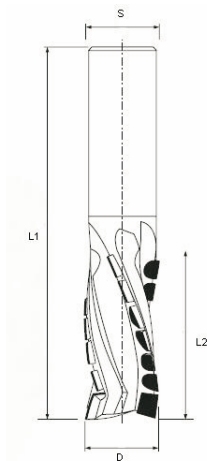

HW · MEC

D	L2	L1	S	Z	Ref.
16	28	91	16	3	8501.16.28.0
16	35	100	16	3	8501.16.35.0
18	28	91	20	3	8501.18.28.0
18	35	100	20	3	8501.18.35.0
18	45	100	20	3	8501.18.45.0
20	28	91	20	3	8501.20.28.0
20	35	100	20	3	8501.20.35.0
20	45	100	20	3	8501.20.45.0
20	55	114	25	3	8501.20.55.0
25	28	91	25	3	8501.25.28.0
25	35	100	25	3	8501.25.35.0
25	45	100	25	3	8501.25.45.0
25	55	114	25	3	8501.25.55.0

APLICAÇÃO

Para ranhurar, fresar, recortar, contornar, em máquinas CNC quando se exige velocidades de avanço altas e acabamentos perfeitos em materiais como aglomerados, MDF, contraplacados, madeiras prensadas etc... revestidos com melamina, laminados, papel decorativo, etc...

DESCRIÇÃO

Grande suavidade de corte devido aos seus 3 cortes helicoidais que facilitam a saída da peça.

Fresa de alto rendimento com grande área disponível para afiamentos.

Com cortante central em PCD para furar.

Avanço de 15-30m/min.

n:18000-24000 rpm.





HW · MEC

D	L2	L1	S	Z	Ref.
20	32	95	20	2+2	8505.20.32.0
20	46	110	20	2+2	8505.20.46.0
25	32	105	20	2+2	8505.25.32.0
25	46	120	20	2+2	8505.25.46.0
20	32	95	25	2+2	8505.20.32.S25
20	46	110	25	2+2	8505.20.46.S25
25	32	105	25	2+2	8505.25.32.S25
25	46	120	25	2+2	8505.25.46.S25

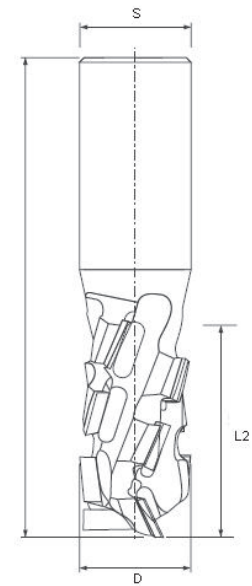

APLICAÇÃO

Para ranhurar, fresar, recortar, contornar, em máquinas CNC quando se requer velocidades de avanço altas e acabamentos perfeitos em materiais como aglomerados, HPL, Trespa, Corian, MDF, contraplacados, madeiras prensadas etc... revestidos com melamina, laminados, papel decorativo, etc...

DESCRIÇÃO

Grande facilidade de avanço devido aos seus cortes Z2+2 com disposição progressiva e ângulos axiais opostos em caixas côncavas que facilitam a saída da aparas.

Fresa de alto rendimento com grande área disponível para afiamentos.

Avanço de 15-30m/min.

n:18000-24000 rpm.





8502 Fresa de ranhurar Fresa para ranurar

01

Ferramentas em diamante policristalino · Herramientas de diamante policristalino

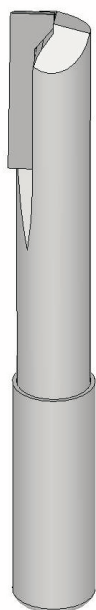

HW · MEC

D	L2	L1	S	Z	Ref.
4	10	60	4x30	1	8502.04.10.0
5	10	60	5x30	1	8502.05.10.0
6	10	60	6x30	1	8502.06.10.0
8	15	80	8x30	1	8502.08.15.0
10	20	80	10x30	1	8502.10.20.0

CORPO EM HW INTEGRAL

cuerpo en Hw íntegral

8503 Fresa de ranhurar Fresa para ranurar



HW · MEC

D	L2	L1	S	Z	Ref.
6	10	60	6x30	2	8503.06.10.0
8	15	80	8x30	2	8503.08.15.0
10	20	80	10x30	2	8503.10.20.0

CORPO EM HW INTEGRAL

cuerpo en Hw íntegral



DP · MEC

D	L2	L1	S	Z	H	Ref.
47	24	90	20x55	2	22	8510.001
65	32	95	20x55	2	31	8510.002

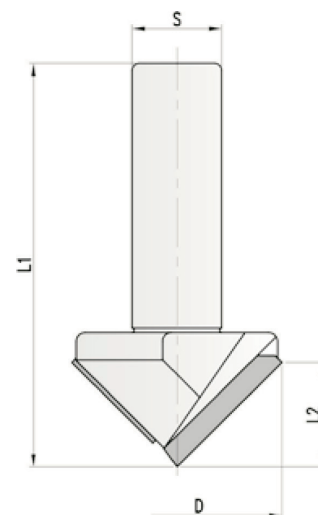
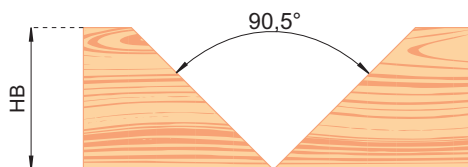

Fresa de perfil 8511
Fresa de perfil

DP · MEC

D	L2	L1	S	Z	Ref.
33,8	15	77	20x55	2+1	8511.001

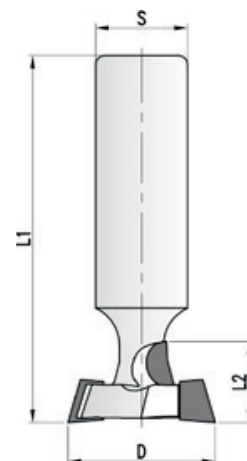
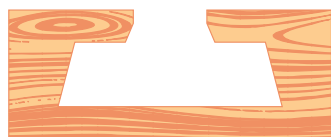

Fresa para facejar 8512
Fresa de cantear

DP · MEC

D	L2	L1	S	Z	Ref.
75	10	75	20x55	8	8512.001

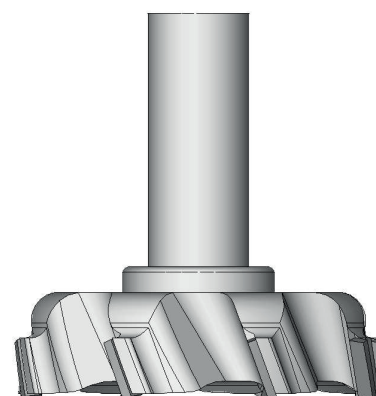



8520 Fresa de PCD para Grafite

Fresa de PCD para el grafito

01

Ferramentas em diamante policristalino · Herramientas de diamante policristalino

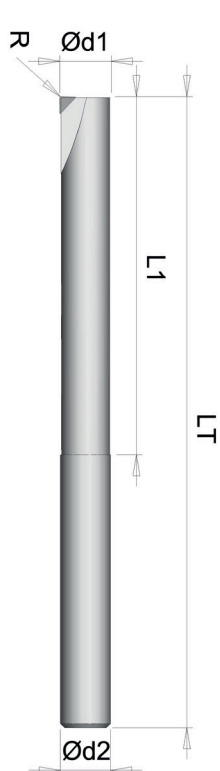

HW · MEC

D1	D2	L1/LT	S	Z	R	Ref.
3,3	3	45	3	1	0,3	8520.065.033.03

CORPO EM HW INTEGRAL
cuerpo en Hw integral

8521 Fresa de PCD para Grafite

Fresa de PCD para el grafito

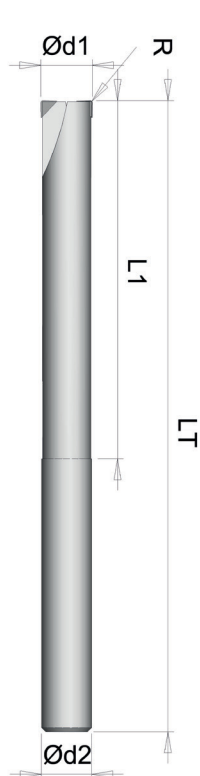

HW · MEC

D1	D2	L1/LT	S	Z	R	Ref.
4	4	45/100	4	2	0,3	8521.100.040.03
4,3	4	100	4	2	0,3	8521.100.043.03
6	4	45/100	6	2	0,3	8521.100.060.03
6,3	6	100	6	2	0,3	8521.100.063.03
8	8	65/125	8	2	0,3	8521.125.080.03
8,3	8	125	8	2	0,3	8521.125.083.03
10	10	80/150	10	2	0,5	8521.150.100.05
10,3	10	150	10	2	0,5	8521.150.103.05
12	12	80/150	12	2	0,5	8521.150.120.05
12,3	12	150	12	2	0,5	8521.150.123.05
12	12	100/180	12	2	0,5	8521.180.120.05
12,3	12	180	12	2	0,5	8521.180.123.05

CORPO EM HW INTEGRAL
cuerpo en Hw integral



HW · MEC

D1	D2	L1/LT	S	Z	R	Ref.
8	8	65/125	8	3	0,3	8522.125.080.03
8,3	8	125	8	3	0,3	8522.125.083.03
10	10	80/150	10	3	0,5	8522.150.100.05
10,3	10	150	10	3	0,5	8522.150.103.05
12	12	80/150	12	3	0,5	8522.150.120.05
12,3	12	150	12	3	0,5	8522.150.123.05
12	12	100/180	12	3	0,5	8522.180.120.05
12,3	12	180	12	3	0,5	8522.180.123.05

CORPO EM HW INTEGRAL
cuerpo en Hw íbtegral

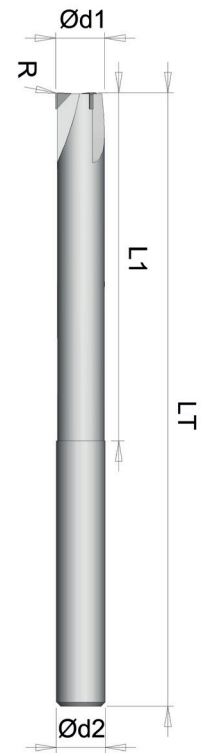

Fresa de PCD para Grafite **8523**
Fresa de PCD para el grafito

HW · MEC

D1	D2	L1/LT	S	Z	R	Ref.
6	6	40/80	6	2	3	8523.080.060.03
8	8	40/80	8	2	4	8523.080.080.04
10	10	40/80	10	2	5	8523.080.100.05
12	12	60/110	10	2	6	8523.110.120.06
14	14	60/110	12	2	7	8523.110.140.07
16	16	80/130	12	2	8	8523.130.160.08
18	18	80/150	12	2	9	8523.150.180.09
20	20	80/150	12	2	10	8523.150.200.10

CORPO EM HW INTEGRAL
cuerpo en Hw íbtegral

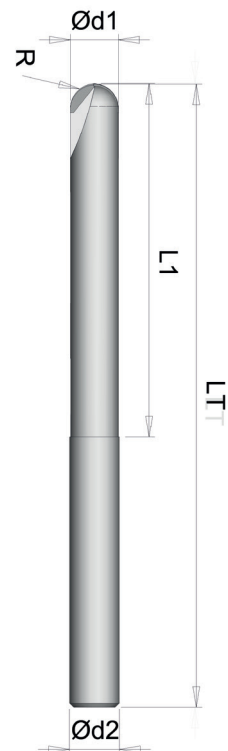

araújo&silva
ferramentas de corte

www.araujosilva.pt